

Four 
Seasons™

USE AND CARE MANUAL

For Model FS87PHLP



**Stop! Missing a part? DO
NOT RETURN PRODUCT
TO STORE**

FOR YOUR SAFETY:

1. Read this Manual before attempting to assemble or operate your patio heater.
2. Follow safety instructions.
3. Check for leaks according to the directions in this Manual before operating your patio heater, even if purchasing an assembled patio heater.
4. Keep this Manual for future reference.
5. Contact **1-800-229-5647** should you need assembly assistance or have any questions.

**The store where you made the purchase does not stock parts for this item. If you need parts, whether they are missing or damaged, please call Customer Service at 1-800-229-5647
Call us between 8:00 AM and 5:00 PM Eastern time, Monday through Friday
or email us at saleshelp@sureheat.com**

Table of Contents

General Safety Instructions.....	3-5
Components & Hardware.....	6-7
Additional Requirements.....	7
Assembly Process	
Step 1 – Attach Wheel Assembly to Base.....	8
Step 2 – Attach Bucket to Base.....	8
Step 3 – Attach Support Brackets to Base.....	9
Step 4 – Attach Post to Support Brackets.....	9
Step 5 – Attach Reflection Studs to Screen Cover.....	10
Step 6 – Attach Head Assembly to Post.....	10
Step 7 – Install Reflector.....	11-12
Step 8 – Attach Reflector Assembly to Studs.....	13
Step 9 – Connect hose & Regulator to Cylinder.....	14
Gas Requirement.....	15
Pre-Operation Leak Testing.....	16
Operation.....	17-18
Care & Maintenance.....	19
Troubleshooting.....	20
Warranty.....	21

General Safety Instructions

IMPORTANT SAFETY INFORMATION

- This manual contains important information about the assembly, operation and maintenance of this patio heater. General safety information is presented in these first few pages and is also located throughout the manual.
- Keep this manual for future reference and to educate new users of this product. This manual should be read in conjunction with the labeling on the product.
- Safety precautions are essential when any mechanical or propane fueled equipment is involved. These precautions are necessary when using, storing, and servicing. Using this equipment with the respect and caution demanded will reduce the possibilities of personal injury or property damage.
- The following symbols shown below are used extensively throughout this manual. Always heed these precautions, as they are essential when using any mechanical or fueled equipment.

RECOGNIZE SAFETY SYMBOLS, WORDS AND LABELS

WARNING indicates a potentially hazardous situation which, if not avoided, could result in death or serious injury.

NOTE indicates an important piece of information that needs to be observed to ensure the proper operation of your heater.

DANGER

If you smell gas:

1. Shut off gas to the appliance
2. Extinguish any open flame
3. Open lid
4. If odor continues, keep away from the appliance and immediately call your gas supplier or your fire department.

WARNING

1. Do not store or use gasoline or other flammable liquids or vapors in the vicinity of this or any other appliance.
2. An LP cylinder not connected for use shall not be stored in the vicinity of this or any other appliance.

INSTALLER: Please retain these instructions with the owner so that they may maintain them for future reference.

General Safety Instructions

⚠ DANGER

DANGER indicates you can be killed or seriously injured if you don't immediately follow instructions.

⚠ WARNING

WARNING indicates you can be killed or seriously injured if you don't follow instructions.

⚠ CAUTION

CAUTION indicates an imminently hazardous situation which, if not avoided, may result in minor or moderate personal injury, or property damage.

⚠ WARNING

Improper installation, adjustment, alteration, service or maintenance can cause injury or property damage. Read the instructions thoroughly before installing or servicing this equipment.

FOR YOUR SAFETY

DO NOT store or use gasoline or other flammable vapors and liquids in the vicinity of this or any other appliance.

An **LP cylinder** not connected for use shall not be stored in the vicinity of this or any other appliance.

⚠ CAUTION

SERVICE SAFTY

- Keep all connections and fittings clean. Make sure propane cylinder valve outlet is clean. Inspect hose before use. Replace if there is evidence of abrasion or wear.
- During set up, check all connections and fittings for leaks using soapy water. Never use a flame.
- Use as a heating appliance only. Never alter in any way or use with any device.
- Check entire hose at least annually.

⚠ DANGER

EXPLOSION - FIRE HAZARD

- Keep solid combustible materials, such as building materials and paper or cardboard, a safe distance away from the heater as recommended by the instructions.
- Provide adequate clearances around air openings into the combustion chamber.
- Never use the heater in spaces which may contain volatile or airborne combustibles, or products such as gasoline, solvents, paint thinner, dust particles or unknown chemicals.
- During operation, this product can be a source of ignition. Keep heater area clear and free from combustible materials, such as gasoline, paint thinner, cleaning solvents and other flammable vapors and liquids. Do not use heater in areas with high dust content. Minimum heater clearances from combustible materials: three (3) feet from the sides & two (2) feet from the top.

FOR OUTDOOR USE ONLY

⚠ WARNING

- We cannot foresee every use which may be made with our heaters.
- Check with your local fire safety authority if you have questions about heater use. Other standards govern the use of fuel gases and heat producing products for specific uses.
- Your local authorities can advise you about these standards.
- If no local codes exist, follow National Fuel Gas Code, ANSI Z223.1. In Canada, installation must conform to local codes. If no local codes exist, follow the current National Standards of CANADA CAN/CGA-B 149.2.

General Safety Instructions

⚠ DANGER

CARBON MONOXIDE HAZARD

- This heater is a combustion appliance. All combustion appliances produce carbon monoxide (CO) during the combustion process. This product is designed to produce extremely minute, non-hazardous amounts of CO if used and maintained in accordance with all warnings and instructions. Do not block air flow into or out of the heater. Carbon monoxide (CO) poisoning produces flu-like symptoms, watery eyes, headaches, dizziness, fatigue and possibly death. You can't see it and you can't smell it. It's an invisible killer. If these symptoms are present during operation of this product get fresh air immediately!
- For outdoor use only.
- Never use inside house, or other unventilated or enclosed areas.
- This heater consumes air (oxygen). Do not use in unventilated or enclosed areas to avoid endangering your life.

⚠ WARNING

- This product is fueled by propane gas. Propane gas is invisible, odorless, and flammable. An odorant is normally added to help detect leaks and can be described as a "rotten egg" smell. The odorant can fade over time so leaking gas is not always detectable by smell alone.
- Propane gas is heavier than air and leaking propane will sink to the lowest level possible. It can ignite from matches, lighters, sparks or open flames of any kind many feet away from the original leak. Use only propane gas set up for vapor withdrawal.
- Propane gas should be stored or used in compliance with local ordinances and codes or with ANSI/NFPA 58. Turn off propane when not in use.

FOR YOUR SAFETY

If you smell gas:

1. Shut off gas to the appliance.
2. Extinguish open flame.
3. If odor continues, immediately call your gas supplier and local Fire Dept.

⚠ DANGER

EXPLOSION - FIRE HAZARD

- Never store propane near high heat, open flames, pilot lights, direct sunlight, other ignition sources or where temperatures exceed 120 °F (49°C). Propane vapors are heavier than air and can accumulate in low places. If you smell gas, leave the area immediately.
- Never install or remove propane cylinder while heater is lit, if pilot light is lit, or ignition source and heater are hot to the touch.
- This heater is red hot during use and can ignite flammables too close to the burner. Keep flammables at least 2 feet from sides & 3 feet from top. Keep gasoline and other flammable liquids and vapors well away from heater.
- The propane cylinder must always be stored outdoors in a well ventilated space. Never store propane cylinder in an enclosed area (House, garage, etc.). If heater is to be stored indoors, disconnect the propane cylinder for outdoor storage.

⚠ WARNING

BURN HAZARD

Never leave heater unattended when hot or in use. Keep out of reach of children.

⚠ DANGER

Failure to comply with the precautions and instructions provided with this heater can result in death, serious bodily injury and property loss or damage from hazards of fire, explosion, burn, asphyxiation, and/or carbon monoxide poisoning. Only persons who can understand and follow the instructions should use or service this heater.

⚠ WARNING

California Proposition 65

Combustion by-products produced when using this product contain chemicals known to the State of California to cause cancer, birth defects, and other reproductive harm.

Components & Hardware

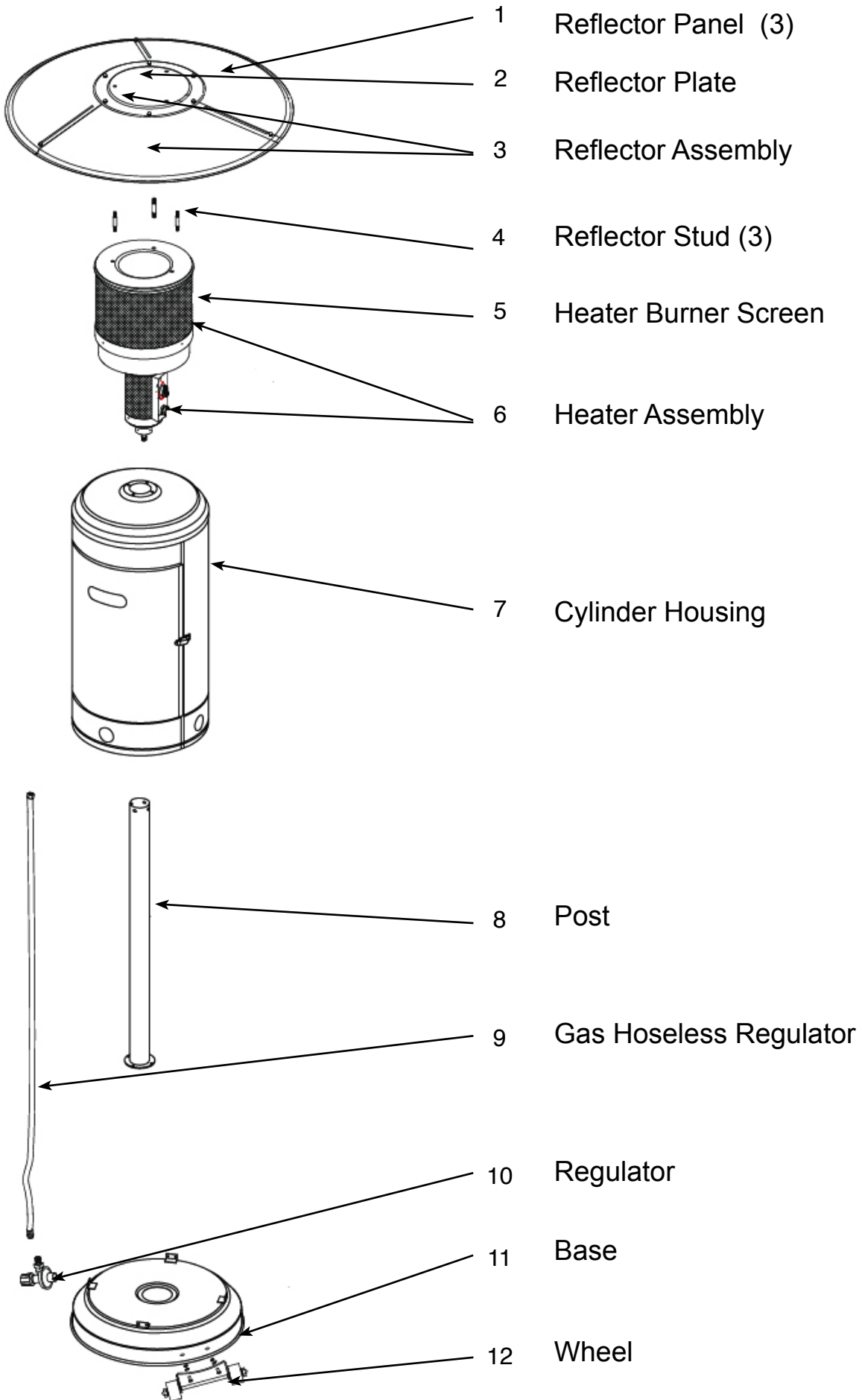

Components & Hardware

Hardware Picture	Qty	Description	Used in Step(s)
	4	Small Bolt	4
	4	Small Flat Washer	4
	4	Small Screw	3
	Total 9	Large Flat Washer	6 & 9
	9	Medium Flat Washer	8
	9	Cap Nut	8
	9	Small screw	8
	3	Wing Nut	9
	3	Reflector Stud	6
	1	Wrench	1 / 3 / 4 / 7 / 8

Additional Requirements

The following items are not included, but are necessary for the proper assembly of your heater. DO NOT attempt to assemble without proper tools.

- Phillips screwdriver w/ medium blade.
- Adjustable opening wrench.
- Leakage Detection Solution (Instructions on how to make solution are included on page 15)

Note: You must follow all steps to properly assemble heater.

Assembly Process

Step 1 - Attach Wheel Assembly to Base

Wheel Assembly



2 Medium bolts / 2 Large Flange Nuts

Line up holes in Wheel Bracket with corresponding holes in base. Insert 2 Medium bolts through holes and finger tighten the 2 Large Flange Nuts.

Be sure that the Wheel Assembly is parallel to the base, and fully tighten bolts.



Step 2- Attach Bucket to Base

Bucket



4 Large Screws / 4 Large Nuts

Slip 4 Large Screws through holes of Base.

Lay Bucket inside of Base and screw on large nut. Tighten with Phillips screwdriver.

To improve stability, the bucket should be filled with sand.



Assembly Process

Step 3- Attach Cylinder Housing to Base

Attach Cylinder Housing loosely to Base with four Small Screws.



Step 4- Attach Post to Cylinder Housing top

Open the door, put post through the hole on the top of Cylinder Housing.



Attach post to Cylinder Housing using four Small Bolts, Nuts and Small Flat Washers.



Assembly Process

Step 5 - Attach Reflector Studs to Screen Cover

Insert 3 Reflector Studs & 3 large Flat Washers.

Tighten studs securely.



3 Reflector Studs



3 Large Flat Washers



Step 6 - Attach Head Assembly to Post

4 Small Bolts Head Assembly

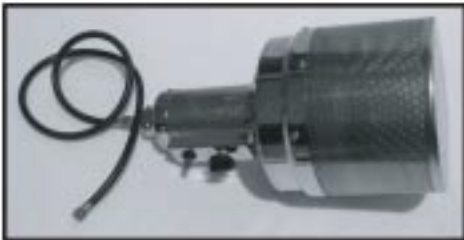

Remove 4 small bolts from the top of the Head Assembly .



Insert hose end into the top of the post and then rest the burner head assembly onto the post making sure that the control knob is positioned above the lighting instructions on the post.



Attach Head Assembly to post, and loosely install four small bolts. Tighten bolts securely.



Assembly Process

Step 7 - Install Reflector

⚠ WARNING

Remove protective film before assembly

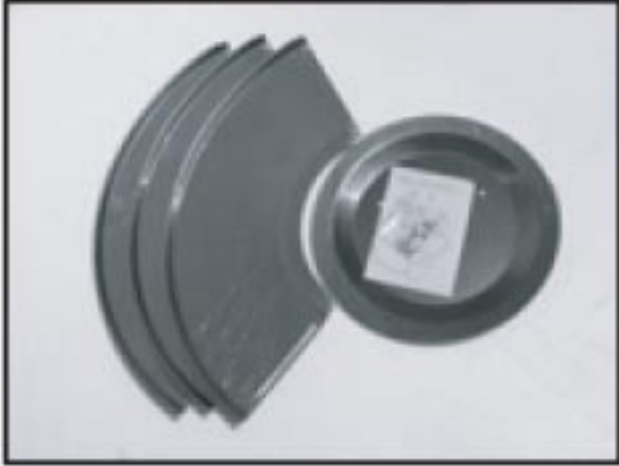

Note: It is necessary for proper alignment of reflector section to loosely install all of the screws for assembly prior to tightening. Once all of the screws have been loosely installed, tighten with a wrench.



9 Small Screws



9 Medium Flat Washers



9 Cap Nuts

Slide two Reflector Panels together.

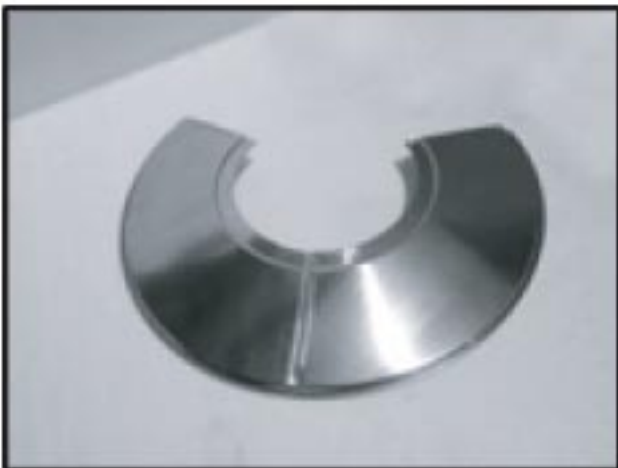

Insert one Small Screw.

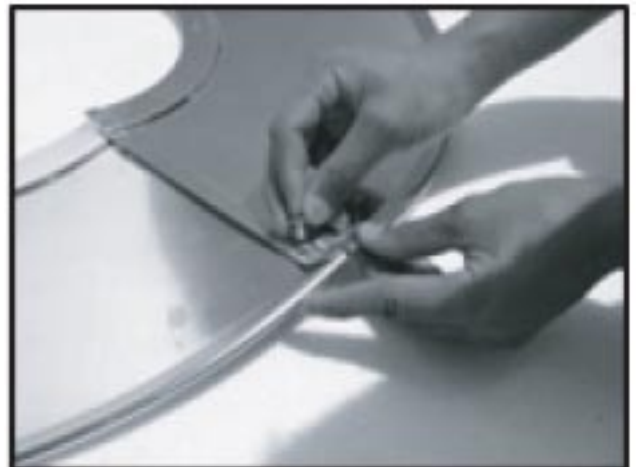

Assembly Process

Slide one Small Flat Washer over threaded end of screw and loosely screw on Cap Nut. Repeat procedure to complete the assembly of all three Reflector Panel sections.

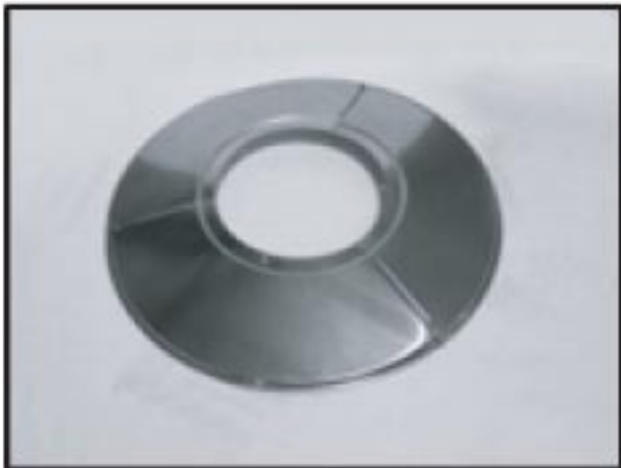

Slide Reflector Plate onto Reflector Panels.
Insert one Small Screw.

Slide one small Flat Washer over threaded end of screw and loosely screw on Cap Nut. Repeat procedure to install the remaining screws.



Once all screws have been loosely installed, tighten all screws with a wrench.

Assembly Process

Step 8 - Attach Reflector Assembly to Studs

Support Heater.

Slide 3 Large Flat Washers over threaded end of Studs.



6 Large Flat Washers



3 Wing Nuts



Install Reflector Assembly onto three (3) studs.

Install large flat washers on studs and securely tighten wing nuts. Make sure not to overtighten the wing nuts.



Assembly Process

Step 9 - Connect Hose & Regulator to Cylinder

Specifications

- You must provide propane gas and propane cylinder. Use a standard 20 lb. Propane cylinder only.
- Use this heater only with a propane vapor withdrawal supply system. See Chapter 5 of the Standard for Storage and Handling of Liquefied Petroleum Gas, ANSI/NFPA 58. Your local library or fire department should have this book.
- The **minimum** permissible gas supply pressure of 10 W.C. is required for purpose of input adjustment.
- The installation must conform with local codes, or in absence of local codes, with National Fuel Gas Code, ANSI Z223.1.
- The **minimum** hourly output of 17000 Btu is the required rating of a heater operating at ratings less than full input rating.
- The pressure regulator and hose assembly supplied with the appliance must be used.
- A dented, rusted or damaged propane cylinder may be hazardous and should be checked by your cylinder supplier. Never use a propane cylinder with a damaged valve connection.
- The propane cylinder must be constructed and marked in accordance with the specification for LP gas cylinders of the U.S. Department of Transportation (DOT).
- Never connect an unregulated propane cylinder to the heater.



Standard 20lb. tank

Screw regulator onto gas hose. Do not cross-thread.



Attach regulator to cylinder.
Complete attachment.



Tighten securely.



Install cylinder.



Gas Requirements

L.P. GAS INSTALLATION

Gas Heaters that are set to operate with L.P. gas come with a high capacity hose and regulator assembly. **(Note: Only use the pressure regulator and hose assembly supplied with the heater or a replacement pressure regulator and hose assemblies).** This assembly is designed to connect directly to a standard 20 lb. L.P. cylinder. L.P. Cylinders are not included with the heater. L.P. Cylinders they can be purchased separately at an independent dealer.

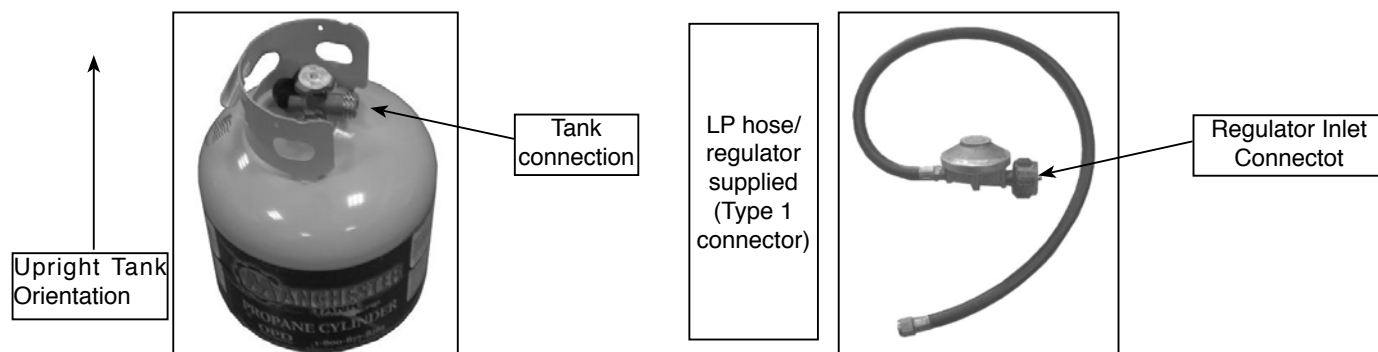

L.P. TANK INFORMATION

Never use a dented or rusted L.P. tank or cylinder with a damaged valve.

L.P. cylinders are equipped with an O.P.D (Overfilling Prevention Device). The device shuts off the flow of gas to a cylinder after 80% capacity is reached. This limits the potential for release of gas when the cylinder is heated, averting a fire or possible injury.

The L.P. cylinder must have a shut-off valve terminating in an L.P. gas supply cylinder outlet specified, as applicable, for connection No. 510 in the standard for compressed gas cylinder valve outlet and inlet connection ANSI/CGA-V-1. Cylinders must not be stored in a building, garage, or any other enclosed area. (The L.P. cylinder must have an overfill protection device, OPD, and a collar to protect the cylinder valve.)

The L.P. gas supply cylinder must be constructed and marked in accordance with the specifications for L.P. gas cylinders of the U.S. Department of Transportation (DOT) or the National Standard of Canada, CAN/ CAS-B339, "Cylinders, Spheres and Tubes for the Transportation of Dangerous Goods and Commission."

L.P. TANK USE

- When turning the L.P. tank on, make sure to open the valve **SLOWLY** two (2) complete turns to **insure** proper gas flow. Most gas tanks now come equipped with a leak detector mechanism internal to the tank, when gas is allowed to escape rapidly it shuts off the gas supply. Opening the valve rapidly may simulate a gas leak, causing the safety device to activate, restricting gas flow causing low flames. Opening the valve slowly will **insure** this safety feature is not falsely triggered.
- When not in use, gas supply cylinder valve is to be in the " OFF" position.
- The tank supply system must be stored upright to allow for vapor withdrawal.
- The regulator and hose assembly must be inspected before each use of the heater. If there is excessive abrasion or wear or if the hose is cut, it must be replaced prior to the heater being used again.
- Cylinders must be stored outdoors out of the reach of children and must not be stored in a building, garage or any other enclosed area.
- Only a qualified gas supplier should refill the L.P. tank.
- Place dust cap on cylinder valve outlet when ever the cylinder is not in use. Only install the type of dust cap on the cylinder valve outlet that is provided with the cylinder valve. Other types of caps or plugs may result in leakage of propane.

⚠ WARNING

DO NOT store a spare L.P. gas cylinder under or near the heater. Never fill the cylinder beyond 80% full.

If this information is not followed exactly, a fire causing death or serious injury may occur.

Pre-Operation Leak Testing

GENERAL INFORMATION

Although all gas connections on the heater are leak tested prior to shipment, a complete gas tightness check must be performed at the installation site due to possible shifting during shipment, installation or excessive pressure unknowingly being applied to the unit. Periodically check the whole system for leaks and immediately check the system if the smell of gas is detected.

BEFORE TESTING

1. Do not smoke while leak testing.
2. Extinguish all open flames.
3. Never leak test with an open flame.
4. Mix a solution of equal parts mild detergent or liquid soap and water.

TESTING

1. Turn off the burner control knob.
2. Turn the top knob of the fuel supply cylinder counter-clockwise (right to left) two (2) rotations to open.
3. Apply the soap solution to connections of the fuel supply assembly. If no soap bubbles appear, there is no gas leak. If bubbles form at the connections, a leak is detected. If a leak is detected, immediately turn off the gas supply, tighten any leaking fittings, turn gas on, and repeat steps 1-3.
4. Turn off the knob on the fuel supply cylinder.
5. Turn on the burner control knob for a moment to release the pressure in the hose, then turn the control knobs back off.
6. Wash off soapy solution with cold water and towel dry.

Check all gas supply fittings before each use and each time the gas supply cylinder is connected to the regulator. Have a qualified service technician leak test the heater any time a part of the gas system is replaced.

Also it is recommended to perform a leak test at least once a year whether or not the L.P. gas supply cylinder has been disconnected.

WARNING

When leak testing this appliance, make sure to test and tighten all loose connections. A slight leak in the system can result in a low flame, or hazardous condition. Most L.P. gas tanks now come equipped with a leak detector mechanism internal to the tank, when gas is allowed to escape rapidly, it shuts off the gas supply. A leak may significantly reduce the gas flow making the heater difficult to light or causing low flames.

WARNING

If you cannot stop a gas leak turn off the gas supply and call your local gas company or the dealer you purchased the appliance from. If necessary, replace the faulty part with the manufacturer's recommended replacement part. A slight leak could cause a fire.

Operation

Do not attempt to "Light" the Heater if the odor of gas present!!

BEFORE TURNING GAS SUPPLY ON:

1. Your heater was designed and approved for outdoor use only. DO NOT use it inside a building, garage, or any other enclosed area.
2. Make sure surrounding areas are free of combustible materials, gasoline, and other flammable vapors or liquids.
3. Ensure that there is no obstruction to air ventilation.
4. Be sure all gas connections are tight and there are no leaks.
5. Be sure the cylinder cover is clear of debris.
6. Be sure any component removed during assembly or servicing is replaced and fastened prior to starting.

BEFORE LIGHTING:

1. Heater should be thoroughly inspected before each use, and by a qualified service person at least annually.
2. If relighting a hot heater, always wait at least 5 minutes.
3. Inspect the hose assembly for evidence of excessive abrasion, cuts, or wear. Suspected areas should be leak tested. If the hose leaks, it must be replaced prior to operation. Only use the replacement hose assembly specified by manufacturer.

LIGHTING:

Note: This heater is equipped with a Pilot light that allows for safer startups and shutdowns. The pilot must be lit before Main Burner can be started.

1. Turn Cylinder Valve ON.

2. Open Viewing Hole by sliding cover to either side.

3. Push Control Knob IN and rotate to Pilot position.



Note: For initial start or after any cylinder change, hold Control Knob IN for 2 minutes to purge air from gas lines before proceeding.

4. Push and release the igniter button until pilot flame is visible through Viewing Hole.

5. Release Control Knob after 30-60 seconds. Pilot Light will remain lit. If not, Return to step 1.

6. Turn Control Knob to ON. Main burner will light immediately. Flame is visible through Viewing Hole. If not, return to step 1.

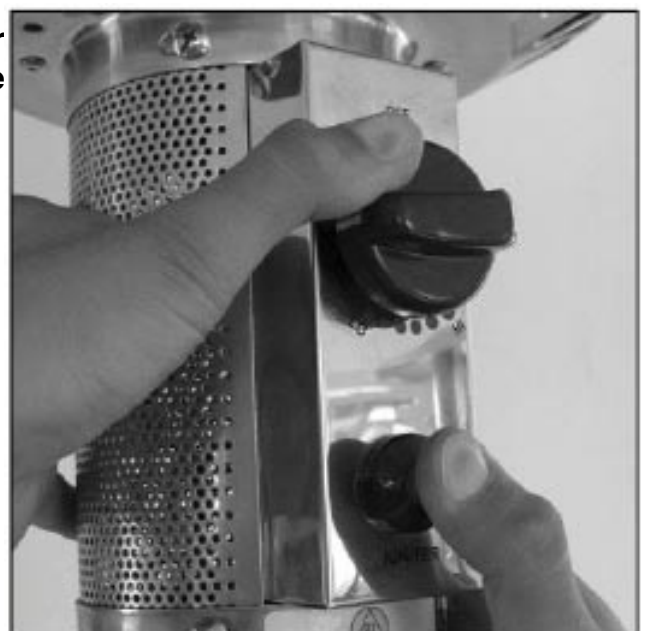

Operation

If for some reason your igniter fails to deliver a spark, your heater can be started by inserting a lit match through the pilot view hole while pushing the control knob in while in the PILOT position.



NOTE:

If pilot fails to remain lit, all valves should be closed and wait at least 5 minutes before attempting to light.

If you experience any ignition problem please consult the Troubleshooting section of this manual.

CAUTION:

Avoid inhaling fumes emitted during initial use. Smoke and odor from the burning of oils used in manufacturing can cause some smoke and an odor. Both smoke and odor will dissipate after approximately 30 minutes. The heater should NOT produce thick black smoke.

NOTE:

The burner may be noisy when initially turned on. To eliminate excessive noise from the burner, turn the Control Knob to the PILOT position. Then, turn the knob to the Level of heat desired.

⚠ WARNING

FOR YOUR SAFETY

Be careful when attempting to manually ignite this heater. Holding in the control knob for more than 10 seconds before igniting the gas will cause a ball of flame upon ignition.

WHEN HEATER IS ON:

Emitter screen will become bright red due to intense heat.

The color is more visible at night.

Burner will display tongues of blue and yellow flame. These flames should not be yellow or produce thick black smoke, indicating an obstruction of airflow through the burners. The flame should be blue with straight yellow tops.

If excessive yellow flame is detected, turn off heater and consult the Troubleshooting section of this manual.

RE- LIGHTING:

Note: For your safety, Control Knob cannot be turned OFF without first depressing Control Knob in PILOT position and then rotating it to OFF.

Turn Control Knob to OFF.

Wait at least 5 minutes, to let gas dissipate, before attempting to relight Pilot.

Repeat the "Lighting" steps on prior page.

⚠ WARNING

FOR YOUR SAFETY

Heater will be hot after use. Handle with extreme care.

SHUT DOWN:

Turn Control Knob clockwise to pilot. (Normally, burner will make a slight popping sound when extinguished) Burner will extinguish but Pilot will remain ON.

To extinguish Pilot, depress Control Knob and continue to turn it clockwise to OFF.

Turn Cylinder Valve clockwise to OFF and disconnect Regulator when heater is not in use.

Note: After use, some discoloration of the emitter screen is normal.

Care and Maintenance

To enjoy years of outstanding performance from your heater, make sure you perform the following maintenance activities on a regular basis:

Keep exterior surface clean.

Use warm soapy water for cleaning. Never use flammable or corrosive cleaning agents.

While cleaning your unit, be sure to keep the area around the burner and pilot assembly dry at all times. Do not submerge the control valve assembly. If the gas control is submerged in water, DO NOT use it. It must be replaced.

Air flow must be unobstructed. Keep controls, burner, and circulating air passageways clean. Signs of possible blockage include:

- Gas odor with extreme yellow tipping of flame.
- Heater does NOT reach the desired temperature.
- Heater glow is excessively uneven.
- Heater makes popping noise.
- Spider and insects can nest in the burners of this or any other heater and cause the gas to flow from the front of the burner. This is a very dangerous condition which can cause a fire to occur behind the valve panel, thereby damaging the heater and making it unsafe to operate. We recommend you check the heater and remove any spiders, insects and webs at least once a year to reduce this risk.
- Carbon deposits may create a fire hazard. Clean reflector and burner screen with warm soapy water if any carbon deposits develop.

Note: In a salt-air environment (such as near an ocean) corrosion occurs more quickly than normal. Frequently check for corroded areas and repair them promptly.

⚠ WARNING
FOR YOUR SAFETY
DO NOT touch or move heater for at least 45 minutes after use.
Reflector is hot to the touch.
Allow reflector to cool before touching.

TIP:
Use high quality automobile wax to help maintain the appearance of your heater. Apply to exterior surface from the pole down. Do not apply to emitter screen or domes.

STORAGE:

- Turn Control Knob OFF
- Disconnect LP source
- Store heater upright in an area sheltered from direct contact with inclement weather (Such as rain, sleet, hail snow, dust and debris).
- If desired, cover heater to protect exterior surfaces and to help prevent build up in air passages.

NOTE:

Wait until heater is cool before covering.

Troubleshooting

BEFORE CALLING CUSTOMER SERVICE

If the heater does not function properly, use the following checklist.

If the problem is:

And this condition exists:

Then do this:

Pilot won't light NOTE: Heater operates at reduced efficiency below 40 °F and 5 °C .	Cylinder valve is closed	Open valve
	Blockage in orifice or pilot tube	Clean or replace orifice or pilot tube
	Air in gas line	Open gas line and bleed it (pressing control knob in) for not more than 1-2 minutes or until you smell gas
	Low gas pressure with cylinder valve fully open	Turn cylinder valve OFF and replace cylinder
	Igniter fails	Use match to light pilot; obtain new igniter and replace
Pilot won't stay lit	Dirt built up around pilot	Clean dirt from around pilot
	Connection between gas valve and pilot assembly is loose	Tighten connection and perform leak check
	Thermocouple is not operating correctly	Replace thermocouple
Burner won't light	Gas pressure is low	Turn cylinder valve OFF and replace cylinder
	Blockage in orifice	Clear blockage
	Control knob is not in ON position	Turn control knob to ON
Burner flame is low	Gas pressure is low	Turn cylinder valve OFF and replace cylinder
	Outdoor temperature is less than 40 °F and tank is less than 1/4 full	Use a full cylinder
	Supply hose is bent or kinked	Straighten hose
	Control knob fully On	Check burner and orifices for blockage
Carbon build-up	Dirt or film on reflector and burner screen	Clean reflector and burner screen
Thick black smoke	Blockage in burner	Remove blockage and clean burner inside and outside

LIMITED WARRANTY

Sure Heat Mfg warrants that the components of this appliance are warranted free from defects in material and workmanship for one year from the date of purchase. Sure Heat Mfg. at its option, will repair or replace this product or any component of the product found to be defective during the warranty period. Replacement will be made with a new manufactured product or component. If the product is no longer available, replacement may be made with a similar product of equal value. This warranty does not include transportation or shipping costs of any kind. This is your exclusive warranty.

This warranty is valid for the original retail purchaser from the date of initial retail purchase and is not transferable. Keep the original sales receipt. Proof of purchase is required to obtain warranty parts.

This warranty does not cover normal wear of parts such as scratches and dents of the components or damage resulting from any of the following:

- negligent use or misuse of the product, including exposing the product to chemicals or cleaning products not approved by Sure Heat Mfg.
- corrosion, rust or discoloring of any kind.
- use or installation contrary to specified instructions and applicable building codes, including heating the product to temperatures above its rated specifications which can cause considerable warping
- disassembly, including removal of the product from a built-in installation
- damage resulting from accident, alteration, misuse, abuse, hostile environments, or improper installation
- repair or alteration
- acts of God, such as fire, flood hurricanes, and tornadoes
- gas cylinders, propane tanks or other fuel delivery systems, including connections to a household fuel supply
- usage other than single-family household use such as commercial or industrial use
- minor warping or discoloration of parts, which is normal and not a defect under this warranty

DO NOT RETURN THIS PRODUCT TO THE PLACE OF PURCHASE

If the appliance does not operate properly, first thoroughly carry out the instructions provided with the unit to ensure that the appliance is installed correctly and check the troubleshooting section in the use and care manual.

We recommend you return the warranty registration card so that you can be contacted with any questions of safety arise that could affect you. The return of the warranty registration card is not a condition for warranty coverage.

Because of continuing product improvement these specifications are subject to change without notice.

If you have other questions or need replacement parts contact our

Customer Service Hotline at (800) 229-5647 or

visit our website at www.sureheat.com

Sure Heat Manufacturing 1861 West Oak Parkway Marietta, GA 30062